

# Computer News PC

P.O. BOX 50127 CASPER, WY 82605

307-265-6483

MAY/JUNE 1996 VOLUME 4 NUMBER 3

\$4.00

## INDEX

## EDITORIAL COMMENT

### WINDOWS ISN'T EVERYTHING AND OTHER GUI'S Part I

by Nancy A. Black Page 2

### ALITE, AN INEXPENSIVE BUT POWERFUL SPREADSHEET

by Harold J. Hendriks Page 4

### WOMEN, THE WEB AND WORK

by Rita Laws, Ph.D Page 8

### SAVE & GO REVIEW

by Danny C. Mullen Page 10

### HARD DISKS + WARRANTIES = HEADACHE

by Danny C. Mullen Page 11

### DRAFTCHOICE REVIEW

by Stan Slater Page 11

### A OPEN ACER COMPUTER

Page 12

### COMPUTER NEWS PURCHASING CLUB

Page 12

### DISCOUNT SOFTWARE Page 12

### ILLUSTRATIONS Page 13

### SHOPPING GUIDE Page 21

### PRINTER RIBBONS Page 30

### CNPC PRODUCT GUIDE Page 31

Danny Mullen one of CNPC's frequent authors, who should be familiar to all our subscribers, has been kind enough to create a very attractive and useful Index of all the CNPC issues and articles. If you do not have a copy of this program you should - it's free.

Just ask for it when you order anything from CNPC, or send \$2 to cover postage and handling if ordered alone.

We use the CNPC Index all the time to research articles that we have printed in the past. And it is a great piece of programming by Danny. We appreciate his efforts.

CNPC now has all of the Parsons Programs in stock at reduced prices for CNPC subscribers. And we are offering to scan your family snapshots for you for free with the purchase of their \$29 Family Origins program. Family Origins is a geneology program where you can build a family tree and if you have windows you can enter a snapshot picture into each individuals detail screen.

Even if you are not into family geneology, it is a great program for just placing the picture and details of each of your immediate family on a disk. Use your digital snapshot to make an ID file on a disk for each of your children, or use the StarFlic program by Trius software, you can create a home movie of your childrens and grandchildrens snapshots; here is a great idea, why not have a screen saver with your childrens pictures that will come up on the office computer every time

you are away from the keyboard.

Remember though you need a scanner and if do not have one let us scan your snapshots into digital files for you.

----

While mentioning services that can be provided by CNPC, we are now in a better position to offer you computer systems at really low prices, due to a new program developed by the manufacturer of the ACER line of computers, monitors, keyboards, and many other items such as soundboards.

Acer is fast outselling even IBM when it comes to PC hardware. The reason. You can purchase basic set of hardware for just what you want to use it for, rather than shelling out \$1,600 or more for a computer that has many things built-in that you would never use. Such as stereo sound, if you only need a computer for the office or you are not interested in playing nineteen-too type games.

The Acer concept is to allow selected distributors to assemble customized computers, using the latest technologies and then letting the seller add in the field, the features which a user might want as needed.

A basic workstation computer from CNPC can now be had for as low as \$995 complete with color monitor. But we will give you more details about this computer later on in this issue.

----

MAY/JUNE  
1996

# WINDOWS ISN'T EVERYTHING AND OTHER GUI'S, PART I

by Nancy A. Black

Many users of older computers may yearn for the ease of use promised by Windows, especially the new Windows 95. As even some 486 systems will require memory upgrades to be able to handle Windows 95, this places many users of 386 computers in the "obsolete" ranks. A graphical user interface is easier for some people to learn and use, and even those of us who are quite happy typing in text commands can learn to appreciate many of the virtues of a GUI, while declaring all the while that we don't need it.

All is not lost for those who yearn for a graphical user interface for their system but are unable to invest in a new computer system that will accommodate Windows 95 or Windows 3.11. All is not lost, that is, if you can locate a copy of Digital Research's GEM or one of the GUI'S produced by GEOWorks. While this article concerns Digital Research's GEM and some GEM applications, I'll try to take a look at the GEOWorks products at a later date.

GEM/3 came bundled with my AMSTRAD PC 20 computer. The bundle included GEM Paint and DR Doodle for the AMSTRAD PC 20. I later acquired Timeworks PUBLISH-IT LITE! which runs under GEM/3 and comes equipped with a basic version of GEM/3. Still later I acquired a used bundle of programs that included GEM/3 Desktop, release 3.1, GEM Publisher, GEM Word Chart, GEM Graph, and GEM Draw Plus. Other GEM applications once available that I have not found are Timeworks' PUBLISH-IT!, GEM First Word Plus (a word processor), GEM Scan, and GEM Artline. I have acquired Digital Research's ARTLINE, version 2.0, which will run under GEM though GEM is not required. Apparently there was

an earlier version of ARTLINE, known as GEM Artline, that did require GEM to run. Because of my relatively small hard drive (20 mg) on my AMSTRAD, I've never attempted to load ARTLINE version 2.0 on the AMSTRAD. Instead, I installed it on my new Pentium, where it runs very well and can be accessed from Windows 3.11. I'm sure there were some other GEM applications made available, other than those I've listed here, but I've either not found references to them or seen them.

Although the GEM/3 installed on my AMSTRAD PC 20 would run on the unexpanded 512 K machine, most of the programs I later acquired, including Publish-It Lite! would not. If you want to run GEM/3 and its applications, I highly recommend you try to upgrade your computer's memory to 640 K if it is now less than that. Once I upgraded the memory of my AMSTRAD I had no further problems with any of the programs. The manual for GEM/3 lists these requirements: IBM PC, XT, AT 100% compatible computer, must have graphics card installed, a minimum of two disk drives or one floppy and one hard drive, DOS 2.1 or higher, and 512K memory. GEM will run on computers with two floppy drives, although a floppy and a hard drive are better. With two floppy drives you may have to make a separate printer disk to accommodate all the files needed.

GEM resembles early Macintosh interfaces more than the Windows interface. Screens are uncluttered, and can be displayed as windows showing the contents of the different drives. Compared to Windows 3.11, GEM is easy to learn to use, and managing files a much more simple task.

The GEM Desktop is the operating system interface. GEM Desktop uses three terms--folder, application, and document. A folder is the same as a subdirectory. An

application is a particular software program, such as a word processor, a database, etc. Document is a collective term in GEM to describe all types of files.

Now that I've been using Windows 3.11 for a few months, I can truly appreciate the simplicity of GEM. Bring up GEM on your computer and you will see two windows, one labeled C:\GEMAPPS, if you are using a hard drive, and the other window labeled Disk Drives and showing icons for your drives. They, in turn, are labeled as to whether they are floppy or hard disks. Mouse technique with GEM is the same as with other interfaces. GEM responds only to the left button on a mouse. You click once to select, double-click to open an icon, etc. GEM Desktop windows contain a title bar, a close button, and a scroll slider. A Full Box controls the size of the window on your screen, and you can alternative between normal or full size.

What keeps GEM simple is that all operations are performed from the Desktop. There's no need to go to a Program Manager or a File Manager to access programs or perform file maintenance tasks. While not as complex as Windows 3.11, or offering as many features, GEM, as a result, is leaner and, I believe, easier to learn to use. For many people who prefer a graphical interface GEM might be the only one they need. After all, some people use their computers for a limited number of tasks: word processing, keeping various databases of information such as household inventory, cooking recipes, book and tape inventories, address books, and household finance and record keeping. They don't need the power of Windows, and have neither the time, the interest, nor, in some cases, the money to surf the Internet, or indulge in any of the myriad of activities the computer makes possible today.

GEM classified applications into two categories: DOS and GEM. You can run most DOS applications from the GEM Desktop after configuring them for use with GEM. GEM applications, of course, require no configuration.

The GEM Desktop includes some accessories, a clock, calculator, and print spooler. Other accessories were said to be available from Digital Research and from other companies. It's possible that you might find some of these included with a used bundle of GEM software, although I have never seen any.

You can display GEM window contents in text form as well as in icon form. The text display gives additional information, including the date the file was created. If you've used Windows 3.11 and winced at the steps you must take to get to File Manager, and shaken your head when you finally got there, you'll appreciate the simplicity of bringing up needed information about your files.

DR Doodle is a simple drawing program that is suitable for beginners. Doodle has been around for a long time. It was a popular Commodore 64 program for many years. I found my Commodore 64 copy some time ago, either at a flea market or in a consignment shop. I honestly forget just where I found it, but fortunately it is complete with a manual. Early Commodore magazines frequently mention Doodle, so I suspect it was widely used.

GEM Desktop Publisher, Release 2, is a full-featured desktop publishing program that has many similarities to Timeworks PUBLISH-IT LITE!, although it is more flexible and has more features than PUBLISH-IT LITE!. One feature that attracted me about this program was that I could format and print in either landscape or portrait orientation, something you

can't do with some other desktop publishing programs that will run on older computers.

GEM Paint and GEM Draw Plus are simple to use painting and drawing programs. GEM Graph is a presentation graphics program that will use data directly from your keyboard, or from spreadsheet and database programs, such as Lotus 1-2-3, Supercalc, and dBase III. GEM WordChart is a program for creating presentation-quality text charts. GEM WordChart comes with standard templates for creating wordcharts. An example of a "wordchart" is an organization chart.

ARTLINE is a full-featured illustration program, and probably more program than many users will need. If your interests run to graphic design and desktop publishing, ARTLINE can be a bargain. While my limited experience has been with ARTLINE, not the older GEM ARTLINE, I'm sure the programs are similar. ARTLINE can be used with Ventura Publisher, according to the manual.

Locating software for older computers can be a problem. Except for those few programs that are well known, little information may be available about a program that shows up on a close-out, surplus, or used shelf. Support will probably no longer be available, even if the original publisher is still in business. Unless you have access to a lot of old computer magazines, even learning that such programs existed three or four years ago, when your older system was residing on a dealer's shelf, can be next to impossible. Sometimes you just have to take a chance. If the program looks interesting, usable, and the price is right, buy it. If, after giving it a try, you find it isn't of use to you, put it back on the market through a consignment shop or pass it on to someone you know who might find a use for it.

Even when you have knowledge of a program, know you want to buy it, and even have a pressing need for it, it may be next to impossible to find. While this is one of the drawbacks to using an older computer system, the problem exists, though perhaps in not such drastic form, for even those users of "the latest and greatest." It's been just six months since I acquired my up-to-date Pentium, running Windows 3.11, and already Windows 3.11 programs are disappearing. While I took advantage of sale prices for much of the software I initially purchased, programs that I missed or am just now discovering a need for have to be hunted among the surplus and close-out dealers. The problem of locating software when you want it continues. Upgrading your computer system doesn't make it go away.

One secret to locating software is to visit regularly those dealers who carry used software. Computer shows and fairs sometimes put you next to great software buys, but when you are searching for a particular program persistence pays off. I've recounted elsewhere how almost overnight PFS: First Publisher, version 3, disappeared from dealers shelves, so that when I wanted to buy it I could not find it. It took me many months, and many visits to a consignment shop, but eventually version 3 of PFS: First Publisher came on the shelf. Because I already had GEM on my AMSTRAD PC 20, I kept my eye alert for any GEM applications. Eventually a bundle of them appeared.

Frustrating? Yes, but many of us simply can't buy when a product is being hyped. Few people I know can buy what they want at any time. Most of us wait weeks, months, or sometimes years before we can spare the funds to purchase an item. Nor can we afford to trade in our computer systems just because some of the software we



want is no longer available. Instead, we accept substitutes or keep looking. I've seen GEM/3 and PUBLISH-IT LITE! available many times. Sometimes used, sometimes new. At a street price of about \$10 for either program they are bargains. PUBLISH-IT LITE! was also available in a CD-ROM version, which I have seen new at a slightly higher cost. If you'd like to use a GUI, look for GEM/3 and any compatible applications the next time you're at a computer show or swap meet.

-Nancy A. Black

*(Editor's Note)* Every computer user has their favorite program to perform a particular task. Some programs are just as good as others, some are better than others, some are easier to use, some are harder to use. Out of all the thousands of programs written they become just like the streets and roads on a map. Some roads are easier to drive, others are more scenic, while others seem to be shorter to some drivers, even when they are actually longer. Personal choice and experience enters into all things in life. It is the same with computer programs, and for most of use the constraints of how it affects the pocketbook.

We happen to like DIRECT ACCESS, as a simple menu type program which is just another GUI without the icons. It is available in a DOS version and it too is also available in a windows version, however we don't really understand why there is a windows version available except that some people felt that they could not live without the GUI windows. See our review in Vol. 2 No. 6 of CNPC.

DIRECT ACCESS for DOS or Windows is available from CNPC for:

Retail \$99.00

CNPC Subscribers \$84.00

plus \$5 shipping and handling.

## ALITE, AN INEXPENSIVE BUT POWERFUL SPREADSHEET

by Harold J. Hendriks

### A LOT FOR A LITTLE

You can't buy much for \$20.00 nowadays - maybe half a sack of groceries, if your lucky! So, what can you get of 20 Bucks? You can get ALITE, an easy-to-use Spreadsheet Program that is "lite" on system requirements but is loaded with powerful features. ALITE is available from "Computer News PC" for only \$20.00 plus \$5.00 S&H - A REAL BARGAIN!

ALITE, an AS-EASY-AS clone, and the top-notch AS-EASY-AS Spreadsheet Software are products of TRIUS, INC., North Andover, Massachusetts.

### ALITE HIGHLIGHTS

ALITE runs on any IBM or compatible PC with as little as 256K of RAM! ALITE can be used on a 256K TANDY 1000HX PC to create practical and useful Spreadsheets. ALITE supports the use of MONO, Hercules, CGA or EGA monitors.

Depending upon the free memory available, ALITE can be used to create Spreadsheets with up to 2,048 Rows by 128 columns, much larger than many users will ever need.

An intuitive system of Pop-Up Menus make ALITE very easy to learn and to use.

ALITE provides a rich array of powerful and useful functions including Math, Logical, Financial, File Linking, etc.

ALITE features a MACRO Command language, five types of graphs with Merge and Split Screen features, plus File Merge, File Extract, Data Import, Data Sort capabilities and MORE!

ALITE, in addition to being a

good Spreadsheet program, can also be used as a DataBase with selecting, sorting and printing capabilities.

The latest version of ALITE, ver. 1.2R, can be executed in a Terminate and Stay Resident (TSR), or background mode.

ALITE will read files with extensions of "WKS", generated by LOTUS 1-2-3, Ver. 1A, and "WK1", generated by LOTUS 1-2-3 Rel. 2.0, or "WRK", generated by SYMPHONY. NOTE: "LOTUS 1-2-3" and "SYMPHONY" are trademarks of Lotus Development Corp.

### BAD NEWS AND GOOD NEWS!

The bad news for owners and users of pre-386 XT PCs, such as the Tandy 1000 line of PCs, is the ever dwindling availability of good, professional-quality, commercial software, that can be purchased new "over the counter", with support, for such computers. This bad-news scenario has been the subject of several articles in recent issues of "Computer News PC". However, the news isn't all bad; there's good news too. There is some very good software available for users of older PCs.

ALITE is good news for owners and users of older PCs who need and are looking for an easy-to-use, powerful Spreadsheet Program with minimal system requirements.

### ALITE ISN'T A MEMORY HOG!

A Tandy 1000HX PC with a base memory of only 256K and only one disk drive is a minimal computer system. Nevertheless, I have used ALITE on a 256K Tandy 1000HX PC with only one disk drive and running with MS-DOS 2.11 to create and/or load and edit small, but useful, Spreadsheets with a maximum file size of about 11.7K, which corresponds to a Spreadsheet of up

to 12 columns wide by 75 rows long or 15 columns wide by 60 rows long, where the average width of the columns is 9 characters wide. With more memory, ALITE can create and/or load and edit larger SpreadSheets.

With more memory, such as is available, for example, on PCs such as the Tandy 1000SL or 1000SX with a base memory of only 384K, ALITE can create and/or load and edit much larger SpreadSheets (with a file size of up to about 75K, a fairly sizable SpreadSheet).

ALITE is the IDEAL SpreadSheet program for use with pre-386 XT PCs with limited memory, such as 256K or 384K. ALITE can be used effectively on older XT PCs that cannot run most currently available SpreadSheet software. Although a hard disk is nice, as is more than one disk drive, ALITE runs very well from disk on a one-drive system. ALITE's very economical price plus its easy-to-use powerful features are "frosting on the cake" for owners and users older PCs.

#### USE OF AVAILABLE MEMORY

The more free memory that is available after a SpreadSheet Program is loaded, the larger the SpreadSheet that can be created or be loaded from a disk file. When loading a SpreadSheet file from disk, it appears that ALITE, like other SpreadSheet programs, reserves a buffer area in memory that is somewhat proportional to the free memory available. The buffer area is apparently needed for operations such as copying and/or moving blocks of cells, sorting, etc.

On a 256K Tandy 1000HX running under MS-DOS 2.11, Norton Utilities' System Information Utility module reports 215K free for program usage. After loading ALITE, and with a blank spreadsheet form displayed, ALITE reports (at the bottom of the screen), Free: 100% [45K]. Thus it

would appear that 45K is available for SpreadSheet data, but such is NOT the case.

If I try to load an ALITE SpreadSheet file that is larger than about 11.7K (See Previous Section), ALITE displays an "OUT OF MEMORY" message with the additional message that the file may be truncated. After loading the largest file possible without ALITE truncating the file and displaying the "OUT OF MEMORY" message, ALITE reports, Free: 53% [24K]. Thus it appears that an 11.7K SpreadSheet file requires 21K of RAM when the file is loaded into ALITE.

After loading an 11.7K SpreadSheet file into ALITE, it is possible, up to a point, to add to the size of the SpreadSheet and still be able to print it and/or save it to disk. But if this somewhat larger SpreadSheet is saved to a file, it will be truncated when it is again loaded into ALITE.

It appears that when working with a computer with minimal memory, such as 256K of RAM, it is possible to build, print and save a somewhat larger SpreadSheet than ALITE is able to reload from a disk file. It seems that ALITE reserves about 50% of the free memory when it is loading a file from disk.

Be all of this as it may, ALITE can be used very successfully on even a minimal computer, such as a 256K, one-drive, Tandy 1000HX to create, print and save very respectable sized Spreadsheets. BUT, there are limitations!

It appears that a minimum base memory of 512K with a minimum of 256K free after ALITE is loaded is needed to make full and unrestricted use of ALITE's full capabilities.

Nevertheless, ALITE can be used very effectively on systems with

less memory, provided the user does not need to create and/or load and edit very large SpreadSheets. This is not a serious limitation as most owners and users of older pre-386 XT PCs, such as the Tandy 1000HX, 1000SL, 1000SX, etc., usually do not have the need to create and/or to work with very large SpreadSheets.

It's a simple fact of life. You just can't load and haul as much cargo with a Chevy Nova as you can with an 18-Wheeler Peterbilt! The corollary is that owners and/or drivers of Chevy Novas and similar cars usually do not need to routinely haul cargoes of the size that require the use of an 18-Wheeler!

"AS-EASY-AS 1-2-3"

(Note: VisiCalc is a trademark of VisiCorp, Inc. and LOTUS 1-2-3 is a trademark of Lotus Development Corporation.)

Fig. 1. is the print-out of a simple ALITE SpreadSheet. Please refer to the section of "CNPC" that is devoted to program listings and illustrations.

Anyone who has ever used VisiCalc or LOTUS 1-2-3 will feel right at home using ALITE. The display of the MAIN Menu is invoked by simply pressing the forward slash [/] key. Fig. 2. is a "Print Screen" image showing the "Pop up" MAIN Menu superimposed, at the left margin, on the SpreadSheet.

If a "Pop up" Menu is displayed at the left side of the SpreadSheet, its name is displayed at the top-center of the SpreadSheet. For example, if the MAIN Menu is invoked by pressing the [/] key, the word, "MAIN", is displayed at the top-center of the SpreadSheet.

The MAIN Menu lists eleven Options; see Fig. 2. The current position of the bar cursor is shown

by the shaded bar on the Menu. Any Option can be invoked either by simply pressing the key corresponding to the first letter of the name of the Option, or by positioning the bar cursor over the Option and then pressing [ENTER]. For example to select the "File" Option simply press the [F] key and the FILE SubMenu will be displayed. See fig. 4.

Fig. 2. shows the bar cursor positioned on the "Sheet" Option of the MAIN Menu. The third line at the top of the Spreadsheet lists the Options available on the "Sheet" (WorkSheet) SubMenu, namely, Column Width, Delete (row, column), Erase (Sheet), Insert (row, column), General, Summary, Borders, Window.

With the MAIN Menu0 displayed, pressing the [S] key, or positioning the bar cursor on "Sheet" and pressing [ENTER] will display the WSheet (for WorkSheet) SubMenu in place of the MAIN Menu. The notation "WSheet" appears top-center on the Spreadsheet. See fig. 3.

With the MAIN Menu or any SubMenu displayed, positioning the bar cursor on any option results in the listing of the sub options available on the corresponding SubMenu. The list of options is displayed on the third row of the Spreadsheet.

The ALITE screen image on a CGA monitor is much more attractive and pleasing in appearance than a dot-matrix printer is capable of reproducing. The printer cannot reproduce the image of the bar cursor which has to be shaded in by hand.

The ALITE Menuing system is straight forward, intuitive and easy to use. The easiest, fastest, most fun, and most effective way to learn to use ALITE is to load one of the sample WorkSheet files that are provided on the ALITE disk and

then to play around with the resultant Spreadsheet, playing "What IF" games with the various Menu Options. If you make a mistake and spoil the WorkSheet, don't fret, BUT don't Save it either. Just erase the "Sheet" and reload the file. In no time at all the new user will be making effective use of ALITE to create useful Spreadsheets.

#### HELP IS AS CLOSE AS THE [F1] KEY

The "Help" Menu or Index of Help Topics can be called up at any time from within the Spreadsheet by pressing the [F1] function key. Fig. 5. is a "Print Screen" image of the "Help" Menu or Index. For help on setting column widths move the bar cursor to "Column" and press [ENTER]. Fig. 6. is a "Print Screen" image of the "Help" Screen with hints for setting the widths of columns.

The ALITE "Help" Screens provide a helpful and useful addition to the User's Manual.

#### SETTING WIDTHS OF INDIVIDUAL COLUMNS

It is easy to change the width of any column. A very convenient feature of ALITE is the ability to use the Right and/or Left Arrow Keys to either widen or to narrow the current column. Place the cursor within the column to be changed. Press the following keys in sequence,

/SCS

where "/" invokes the MAIN Menu, "S" selects the "Sheet" Option, "C" selects the "Column" Sub Option and "S" selects the "Set" Option. With the cursor still in the column to be set, pressing the Rt. Arrow key widens the column, while pressing the Lt. Arrow key narrows the column. When the column is set to the desired width, press [ENTER]. New users of ALITE will soon find that the option to use the Arrow keys to adjust the width of any column is a very handy and

convenient feature.

#### COPY/MOVE CELLS

ALITE can copy or move the data in a contiguous block of cells to another location on the Spreadsheet. This handy feature provides flexibility and saves the work of retyping text and/or data that is needed in more than one location on the Sheet.

#### FORMULAS

ALITE provides a useful array of formulas that can be used to perform arithmetic and mathematical operations on numbers entered in the Spreadsheet. The following are only three examples of the mathematical operations possible using formulas.

If the following formula is entered into Cell F9,

+F8+C9-E9 [ENTER]

the number displayed in Cell F8 will be ADDED to the number displayed in Cell C9 and then the number displayed in Cell E9 will be SUBTRACTED from that SUM. The result will be displayed in Cell F9.

Example 2; if the following formula is entered into Cell F9,

+F8\*C9/E9 [ENTER]

the number displayed in Cell F8 will be MULTIPLIED by the number displayed in Cell C9 and then the resultant PRODUCT of the two numbers will be DIVIDED by the number displayed in Cell E9. The result will be displayed in Cell F9.

Example 3; the @SUM(Range) Function produces the TOTAL or the SUM of the numbers in the specified range in the column or row.

#### USEFUL AND POWERFUL FUNCTIONS

ALITE provides a rich array of



FUNCTIONS, such as STRING, MATH, FINANCIAL, LOGICAL, STATISTICAL, DATE and TIME, and SPECIAL FUNCTIONS which make ALITE a very powerful computational and analytical tool.

ALITE's arsenal of MATH FUNCTIONS include 19 Functions including six trigonometric functions plus Exponential and Log Functions, Square Root, etc.

ALITE's array of Financial FUNCTIONS includes Future Value, Present Value and other useful functions for financial analysis and management.

#### THE @LINK FUNCTION ALITE's

@LINK("Filename > Cell")

FUNCTION is a powerful and very useful function that looks up the contents of a specified cell in a specified WorkSheet File on Disk, and then enters the contents of that Cell into the Cell which contains the @LINK Function on the Current WorkSheet.

A Sales Manager may keep a series of WorkSheets summarizing Quarterly Sales figures for various products, for example, SALES-1Q.WKS for the first quarter, SALES-2Q.WKS for the second quarter, etc.

Assume, for example, that the current quarterly sales figure for a certain product is entered in Cell F12 and that the sales figure for the same product for the previous quarter is entered in Cell F13. The @LINK Function can be used to automatically enter the sales figure for the previous quarter into Cell F13 on the current WorkSheet.

To Link the sales figure for the First Quarter to the Spreadsheet for the Second Quarter, enter the following @LINK Function in Cell F13 on the SALES-2Q.WKS WorkSheet,

@LINK("SALES-1Q.WKS>F12 " )

When the @LINK Function is entered in Cell F13 of the current WorkSheet, the Cell will display 'ERR'. Executing the

/File Uplink

Command will update the Cell containing the @LINK Function. The Sales Figure for the subject product for the previous quarter is automatically entered into the Spreadsheet for the present quarter. There are many useful and convenient applications of the @LINK Function.

#### IMPORTING OF ASCII DATA FILES

Specially formatted, delimited ASCII Data Files can be imported into ALITE Spreadsheets.

While the ALITE User's Manual contains no information on importing ASCII data files into ALITE, a HELP File entry gives a few hints as to how to import data.

I have exported data in the form of a delimited ASCII data File from a Profile Four Plus DataBase file on my TRS-80 Model 4P computer. Using David Miller's MS-Utilities I copied the TRS-80 File to an MS-DOS formatted disk and then imported the data into an ALITE Spreadsheet.

I will be writing a special article on the subject of importing ASCII data into ALITE for a future issue of "Computer News PC".

#### PRINTER COMPATIBILITY

ALITE requires no special Printer Drivers as all text and numbers are sent to the printer via the LPT1 Port as straight ASCII data. The Options available on the PRINTER Menu provides for entering printer control codes for controlling the printer and accessing special features provided by your printer. A wide variety of graphs can be printed using any EPSON or

other fully-graphics compatible dot matrix printer.

An ALITE Spreadsheet, or a portion thereof, can be "printed" to an ASCII File on disk. Such an ASCII file can be imported into a word processing file.

#### DOCUMENTATION

The 6 inch x 8.5 inch, 93 page, paper backed User's Manual for ALITE is on the "lite" side of being an adequate User's Manual for new users of spreadsheet software. In contrast to the User's Manual, while the ALITE program is "lite" on system requirements, it is a "HEAVYWEIGHT" in performance.

The "Table of Contents" and the "Index" are fairly complete and are a real aid to finding specific topics.

The BASICS are briefly, but adequately covered for new users to get up and running with ALITE. An adequate amount of space and details are devoted to such subjects as "File Management", "Printing" and "Graphs".

A novice Spreadsheet user unfamiliar with such things as Statistical and Logical Functions will find the coverage of FUNCTIONS to be too brief. The subject of MACROS is covered fairly well.

Software documentation has been a sore issue for computer users from day one of the personal computer revolution. There are software programs with much better and more adequate documentation than provided by the ALITE User's Manual - BUT, on the other hand, I have seen and used much poorer and much skimpy documentation.

If I were to rate software documentation on a scale of 1 to 5, with a rating of 1 being inadequate or very poor, to 5 being excellent, I would have to rate the

ALITE User's Manual as being a 2.5. On the other hand, I would rate the ALITE Program as being a 4.5.

The HELP Screens, which are as close as the [F1] Function Key, supplement the User's Manual and are a big help on some subjects that need additional clarification. For example, the HELP Screens provided me with the clues needed to import ASCII Data files into ALITE.

Fortunately, ALITE's Pop-Up Menu System is so good and intuitive, that with the help provided by the HELP Screens, the new user can be up and running with ALITE in a reasonable amount of time.

The general form of the command to start the ALITE program is:

ALITE /Sw1/Sw2/Sw3/..

The User's Manual briefly explains the various Switch options. The one that will give the new user the most trouble is the Set Colors Switch,

SET=\$MGFB switch

which sets the colors for the Menu Window, Graph, Foreground and Background, respectively. I use the abbreviated form,

SET=\$FB

which accepts the default colors for the Menu Window and Graphs and sets only the Foreground and Background colors. For a Tandy CM CGA Color Monitor, I have found that

SET=\$32

provides the best combination of colors.

I use the following Start Up Command which I have put into a GO-ALITE.BAT file to start the

program.

ALITE /Q/SET=\$32/TP=-/BK=50

The Switch, /BK=50, sets screen to blank after 50 seconds of inactivity.

#### ALITE SUMMARY

ALITE is a "FIVE-STAR" program for users of the older, pre-386 XT PCs. It's a GREAT Program and a REAL BARGAIN. I highly recommend it. "Computer News PC" has ALITE in stock for immediate shipment.

#### PIVOT!

PIVOT!, another TRIUS Software Product, is a companion program for use with AS-EASY-AS and ALITE. As its name implies, PIVOT! can "flip" a wide SpreadSheet on its side and print it lengthwise, in the Landscape mode, on the page. PIVOT! supports either a 9-pin MX/RX Epson or a 24-pin LQ-2500 Epson dot matrix printer or other printers with compatible emulation modes.

It was only a week ago that I acquired PIVOT! Consequently, I haven't had the time to really try out all its features and capabilities. Suffice it to say for the present, that PIVOT! does a satisfactory job of printing ALITE SpreadSheets sideways on my Panasonic KX-P2023 dot matrix printer operated in the Epson LQ-850 Emulation mode.

PIVOT! is available for ONLY \$15.00 plus \$5.00 S&H from "Computer News PC".

Look for a Review of PIVOT! in an upcoming issue of "Computer News PC".

Goodbye and Happy Computing  
-Harold J. Hendriks

## Women, the Web, and Work

by Rita Laws, Ph.D.

The number of women on the Internet, and on the fastest growing part of the Internet, the World Wide Web, has exploded in the last year. A January 1996 research survey by FIND/SVP found that half of the 9.5 million Internet users in America logged on for the first time during 1995! However, when it comes to women, a whopping 71% of the women on the Internet began using it in 1995. So even though only 31% of the people online today are women, women are discovering cyberspace in much larger numbers than men. I see this everyday. Where once I might have been the only woman in a Usenet Newsgroup online discussion, there is typically a female representation of one-third or more in the chats and discussions I frequent today.

#### JOBS

With so many women needing or wanting to own their own business, or to find ways to stay home while also earning a paycheck, the proliferation of at-home computing careers is good news. Of the many different computing and related-technology careers, most can be enjoyed working from the home, a claim few other career fields can make. Part-time and full-time work are both readily available. Even better is the fact that the number of jobs in computer technology, especially in small businesses, are growing in number each year. In the past year, the 2,000 fastest growing high-tech companies created 92,000 jobs, and 1996 is expected to surpass that. A book by CorpTech and Peterson's called Peterson's Hidden Job Markets 1996 proclaims:

"Over the past 25 years, the number of jobs in the U.S. has grown by almost 50% and small Businesses have been the primary source of these new jobs- nearly



70% of them! Among small businesses, those in the high-tech industry have been and are expected to remain the fastest growing."

### COMPUTING VS. COMPUTERS

The difference between a career in computing and one in computers is roughly the difference between software and hardware. People who build and repair PCs and other hardware components like peripherals, usually need formal credentials such as a certificate of training or a degree in computer science.

Computing careers, on the other hand, refer to those jobs that the self-taught or that the informally trained can apply for, i.e., software development or working online in "cyberspace."

Cyberspace, or the Internet, is what Vice-President Gore and the media like to call the "Information Superhighway."

Breaking into a career in computing is different in significant ways from other fields. For example, computing careers:

- \* span a variety of areas, i.e., online service positions, BBS Sysops, World Wide Web Webmasters, Usenet Newsgroup Moderators, Web page designers, and software development, sales, and public relations,

- \* need new people, including qualified women,

- \* rarely require technical credentials,

- \* can be approached through numerous volunteer roles,

- \* can be approached from several different job avenues using a PC,

- \* and, for women, is a field where others are networking to bring more women into what is usually perceived as a "man's job".

### THE INTERNET

To understand what kinds of jobs are available, it helps to understand what the Internet is.

You may have read that it began life in the 1970's government project called Arpanet, and was designed to give the military an additional means to communicate. For years, the International Network, or Internet was the sole purview of government contractors, and academic and government institutions. But as it grew, and the home computer technology and prices improved, the "Net" was taken over by everyday business people, home makers, kids, seniors, everyone who wants to get 'wired.'

### NET JOBS

The fast-growing Internet is truly a frontier experiencing a gold rush, and because of improving multimedia software, the Web is a boom town. Like any fast growing community, work is plentiful if you know where to look for it. No one owns the Net and using it is free, but access, unless you are a college student or government employee, is usually not free. It's like having to pay to use the onramp of a freeway. There are a host of volunteer and paid jobs on the Net, and many of the latter are filled by former volunteers. Here are the major parts of the Net, and their corresponding jobs:

#### \* Email

Email is telephone-fast electronic messaging. Email may be the Internet's simplest and most important function. In addition to receiving and sending private messages, you can get on email mailing lists or "listservs" and carry on a conversation with folks all over the world that are interested in the same things you are. There are thousands of listservs for every imaginable interest. Email newsletters and advertising businesses are also multiplying rapidly. Listserv managers, called owners, are volunteers who maintain the list, compile the newsletter, and moderate the discussion to keep it on track and at least a little bit civil. This role can lead to paid work of a related nature as

expertise is gained. Email newsletter editors can be volunteers or paid journalists, and a minimum of computer expertise is required.

#### \* Usenet Newsgroups

Newsgroups are international bulletin board discussions, that is, you leave a note, return, and read the replies to it. There are an estimated 20,000 newsgroup discussions worldwide on the Internet on everything humans are interested in, from acrobatics to zoology. Some newsgroups are moderated or controlled by topic experts who attempt to keep the discussion flowing and on topic.

Official and unofficial moderator positions (hang around any unmoderated newsgroup long enough and you will become an unofficial moderator) are volunteer roles but can lead to paid work like webmaster jobs and jobs in the area of interest. For example, education-related newsgroups often include posts about job openings at universities and other institutions. Some schools post their job openings on the Internet first, in order to attract computer-literate applicants.

#### \* BBSs

Bulletin Board Systems, or BBSs, are independent communication services that may or may not connect into the Internet. There are some huge BBSs in the major cities, but most of the nation's 60,000 BBSs are Mom and Pop type enterprises, run from a spare computer in the den. For a small fee, you can sign up and send email, download shareware and other files, engage in live chat or BB type discussions, and play a few online games. The people who run BBSs are called Sysops (System Operators). The large services hire and pay Sysops to maintain the BBS and help new members.

#### \* The World Wide Web

The WWW or the Web, as it often called, is so named because it

resembles the strands of a spider's web in its interconnectedness. A home page, or web site, is like a little electronic library with information and hypertext links to other home pages or strands on the web. A hypertext link is simply a specially colored or highlighted word that, if clicked with the mouse cursor, instantly transports the user to another home page.

The Web is the fastest growing part of the Internet. Conservative estimates count half a million web sites worldwide. The Web is fun, useful, time-saving, and thanks to browsers from Netscape and the major online services, is now very easy to use.

Web companies that make pages for businesses, schools, and research centers, spring up daily. People who can create web pages are in high demand, especially those who can read the hypertext language called HTML. Here's a surprise: HTML is not difficult to learn at all. It's just English, with some keyboard symbols thrown in. Many people self-teach themselves the art of writing in HTML using one of the many books available for this, and then land a part-time job creating web pages.

Another field where people are badly needed is webmastering. This means maintaining a home page after it is created: checking the links to make sure they still work, and adding new information and links over time. Many companies that hire webmasters do not require any knowledge of HTML. You only have to know your way around the Web, which you can learn by playing with it for a few weeks. I went from a total Web neophyte to writing about it for a computer magazine in a span of two weeks.

It is that easy to navigate!

#### JOB HUNTING ON THE WEB

If you have web browser software such as Netscape, or access to the Web through an online

service, a BBS or another provider, you can access web sites full of career information and opportunities. Here are a few you can reach just by typing their "addresses," called URLs, in the URL line of the web browser.

##### 1. Women's Wire

URL: <http://www.women.com>

Women's Wire is an electronic mentoring center with advice columnists, news, resources and help focused on the needs of women. Career advice is plentiful and free.

##### 2. Yahoo Job Link Search

URL: <http://www.yahoo.com>

Search Tools on the Web like Yahoo, McKinley, the WWW Worm and others, act like a card catalog in a library. They look up web sites for you on a particular topic. Yahoo, a popular search tool developed at Stanford University, offers a variety of web sites and is always adding more. Use the search words "internet, jobs" "online, jobs" or "web, jobs" to pull up a good list of resources.

##### 3. Women's Resources on the Net

URL:

<http://sunsite.unc.edu/cheryb/women/wresources.html>

This comprehensive collection of links covers categories from Art to Women's Studies. With dozens of links to newsgroups, gophers, and mailing lists, this site also serves as an excellent introduction to everything the Internet has to offer.

##### 4. Women In Technology Directory

URL: <http://www.sdsu.edu/wit>

This women's networking center is designed to help women further their careers in many different fields and in several different ways. Advertise, make new contacts, and seek advice from other women here.

#### TECHNOLOGY: A WOMAN'S FRIEND

The irony of this situation is that the very technology so many women traditionally fear, is the same technology that can be a woman's best friend, especially a woman who likes the idea of owning her own online services business, or who wants to work from the home. If the surveys are right, women are discovering this simple fact in record numbers.  
-Rita Laws, Ph.D.

#### SAVE & GO REVIEW

by Danny C. Mullen

I just received the utility named above by David Goben and it really is a nice utility. As David states in its documentation, I wish I'd had it when I first started using MS-DOS. It's simple to use and it's really 3 utilities packaged as a set: GO, DIRPUSH, and DIRPOP.

GO lets you cruise your directory trees without fuss and it's quick. It will first scan your hard disk(s) to build a list of all sub-directories that exist at that time. If you add directories later, just re-run GO with the /N parameter to update the list. Once it's got the list, it is quite fast to move to any of those directories - faster than you can type in the whole path, for sure! While I used to use XTREE to navigate my disks, it was necessary to load it and let it scan my disk EACH TIME. GO does not need to scan the disk each time. This is a true time saver. GO will definitely stay on my MOST WANTED (& used) LIST.

Two other utilities named

DIRPUSH and DIRPOP are used together and can be used in conjunction with GO mentioned above. What DIRPOP does is to

save the directory name you are currently in while you move to another.

It can save up to three at a time. When you want to get back fast to the original one, type DIRPOP and BAM!!, you're there. I haven't seen anything as fast as this (except GO). The last directory name saved by DIRPUSH is the first one you'll go to by typing DIRPOP. So, if you had three names stored, and wanted to get to the first one, you'd have to type DIRPOP more than once. Note if you have the MS-DOS command DOSKEY loaded you could use the arrow keys to bring DIRPOP back up to the command line instead of typing DIRPOP or DIRPUSH each time!

One point not mentioned in the manual is that DIRPUSH loads a small TSR program the first time it's used. This allows it to store the directory names in memory. It can't be uninstalled unless you re-boot the computer. Note that it is only a few hundred bytes, so don't worry about it eating too much memory. Also, being the adventurous type, I tried loading DIRPUSH high by using the LOADHIGH (LH) dos command (e.g. LH DIRPUSH) and it then went to upper memory leaving the lower memory area less cluttered. There were no problems noted by doing this, in other words it worked just as well in upper memory.

The utilities come with a three-page manual complete with some background information on directories and the tree structure of MS-DOS disks. It's easy reading and in about five minutes or less, you'll understand all there is to know to use these easy, powerful tools. Thanks David.

-Danny C. Mullen

SAVE & GO by David Gobin is available from CNPC for \$18.95 plus \$5 shipping & handling

## HARD DISKS + WARRANTIES = HEADACHE

by Danny C. Mullen

Last February (1995) I bought a ZEOS machine with a 1 gigabyte harddrive. After only 2 months, the hard disk crashed; that's misery enough for anyone. Well, they replaced it under their 1 year warranty without a fuss. Fifty-one (51) weeks later, that replacement crashed. I called Seagate to inquire on the warranty and they said the ZEOS should cover it. Called ZEOS and they said you only get the one year system warranty plus 1 month in cases like this.

Bad news for the checkbook (translated credit card), but \$259 later I ordered a different model drive from Insight (aka Hard Drives Int'l.). It comes with a three year warranty. So, hopefully, it will give me three years bliss.

The irony is that I'd purchased a second hard disk to add to the system while I was on the second (replacement) drive and it's the same model as the first two - think I'm sweating it out about that one? Yes. I contacted Seagate Tech Support and asked if this was a fluke or did that model drive have inherent problems or a high return rate. They said '.. no more than any other that they manufacture..'. I'm still suspicious! We have 10 year old Seagate drives in some of our machines at work and they are still going strong and I can't get one to last a year! Time will tell.

One thing about this warranty concerns me and I can't prove it, but I seem to remember that the MEDALIST series drives come with a 3 year warranty. Both the old, dead drives are that series as is the new one. I feel I've been given the shaft, but cannot, again, prove it. The model of drives that crashed are the ST31220A IDE model drives. If you have one, I'd suggest a good backup (at any time, of course). I didn't lose any

irreplaceable data, but reinstalling all the software I had was a real pain!

So, if you plan on purchasing a system from anyone, it may pay to ask about claims on parts broken and replaced within their terms and how long the replacements are warranted for. Or, purchase an extended warranty if the price is right.

-Danny C. Mullen

## DraftChoice REVIEW

by Stan Slater

After spending almost 50 years in the construction trades, mostly as an electrical contractor, and consultant I guess a review of DraftChoice falls on my head.

DraftChoice by Trius Software Developers, is a CAD (Computer Assisted Drafting) program which is surprisingly powerful in its ability to produce truly professional looking architectural on a computer that has very little memory required, only 450K minimum of free RAM, however it will support up to 4 MB of memory if you have that much. With 4 MB of memory you could create some fairly huge sophisticated drawings.

A few sample drawing follow these pages to give you an idea of just what could be done with this program and at a price of only \$49 plus \$5 shipping.

If you are familiar with architectural drafting, mechanical drawing or just have the need to create line charts, electrical ladder diagrams, or electrical layouts and you have dreamed of someday owning a program like AutoCad then this is the closest thing you will find to AutoCad.



The program will print your drawing with a dot matrix printer, or a laser printer on 8.5" by 11" paper or 11x17" and if you have a plotter it will print 17x22", 22x34" drawings. The nice part about the program and from my experience, many times we wanted to print something on 8.5 by 11" inch paper and store as a "detail sheet" that represented a layout that would be used over and over on several designs. This meant that all we had to do for a drawing is to refer to "detail number so and so" which would be bound in the specifications book. Also we made many field drawings to describe how we wanted a certain part to be installed. This program would have been a breeze to us over hand drafting and making copies for the work crew.

Along with all the construction designs that the program could produce it nicely produces flow charts, mechanical type drawings or anything else you can think of.

If you are familiar with a CAD program called AutoCAD, the price starts at \$495, plus you need to purchase several modular units to go with it and have a computer system with a very high memory capacity. Plus your investment in plotters, etc.

For the \$49.00 for the DOS version and \$59.00 for the Windows version, you really have a powerful tool at a very reasonable price.

Please see the sample illustrations in this issue, they will give you a basic idea of what you could do with this program.

-Stan Slater



## THE PERFECT WORK STATION COMPUTER FOR UNDER \$1000

by CNPC

As mentioned in our editorial in this issue we are now able to offer complete with a SVGA Monitor for \$995.00 plus shipping.

This AOPEN unit has:  
486DX2 66 MHz CPU,  
AWARD plug & play BIOS  
PCI/ISA BUS  
motherboard by Acer.

256K cache  
4MB RAM  
540 IDE hard drive  
1.44 Meg. 3.5" disk drive  
two 16550AF serial ports  
parallel port  
101 Acer key-board  
3 button mouse  
1MB Trident PCI 32 bit video card  
Microsoft MS-DOS 6.22  
installed ready to go.

14" ACER SVGA non-interlaced monitor.

one year warranty on computer  
three year warranty on monitor.

Components can be added to meet your requirements if needed or wanted.

4X IDE CD-ROM can be added or purchased separately for \$75.00

This unit is especially suitable for the Small Office or Home office (SOHO) use without spending a fortune.

## COMPUTER NEWS PURCHASING CLUB

As many of our readers know we have a purchasing club with annual dues of \$25, which entitles the members to purchase their software and hardware at greatly reduced prices, actually it is "our invoice cost plus a service charge."

We are in a better position to offer you savings on software, computers, printers, and other computer items than ever before.

If you are interested in becoming a Computer News Purchasing Club Member just drop us a line and we will send you additional information.

## DISCOUNT SOFTWARE

These are recently received and are still in their original shrinkwrap store package.

Quicken for Windows	\$15.95
Quicken for DOS	39.00
Musicpower for Guitar	18.00
Easy Quattro Pro (Book)	7.95
Using Windows 3.1 (Book)	9.00
Quick Restart Windows&Dos	12.00
City Streets, Elect. Streets	12.00
Automap Road Atlas DOS	29.95
Automap Road Atlas Wind	29.95
Morph Wizard Windows	9.95
Getting Started Windows	9.95
Learning DOS 6.0	9.95
Word Perfect for DOS	110.00
Corel Word Perfect CD-ROM	
Competitive Upgrade	118.76

Includes:

Corel Word Perfect 6.1  
Corel Quattro Pro spreadsheet  
Corel Presentations graphics  
CorelFLOW  
Sidekick  
Dashboard  
Envoy  
150 fonts  
10,000 clipart images

Quantities are limited on some titles. Add \$5 per order for S&H.

# ALITE, AN INEXPENSIVE, BUT POWERFUL SPREADSHEET - By Harold J. Hendriks

\*\*\*\*\*

ACCT	DATE	CHK #	CODE	AMOUNT	PAYEE	NOTE
NHC	03/05	2345	UELEC	\$82.50	OTTER TAIL PWR CO.	FEB. 1996
NHC	03/09	2351	UTEL	\$53.68	U.S. WEST COMM.	JAN 20 - FEB 19
NHC	03/10	2352	UGAS	\$65.29	N.W. PUB.SERVICE	JAN 18 - FEB 16
NHC	03/10	2353	UWATER	\$16.53	CITY OF MILBANK	JAN 15 - FEB 14
		MARCH	TOTAL	\$218.00		
NHC	04/03	2386	UELEC	\$71.46	OTTER TAIL PWR CO.	MAR. 1996
NHC	04/06	2389	UTEL	\$48.37	U.S. WEST COMM.	FEB 20 - MAR 21
NHC	04/08	2390	UGAS	\$59.28	N.W. PUB.SERVICE	FEB 17 - MAR 18
NHC	04/09	2391	UWATER	\$18.93	CITY OF MILBANK	FEB 15 - MAR 16
		APRIL	TOTAL	\$198.04		
		MARCH +APRIL	TOTAL	\$416.04		

Fig. 1. SAMPLE ALITE SPREADSHEET - UTILITIES EXPENSES FOR MARCH & APRIL

F1:Help 2:Edit 3:Macro 4:Abs | -MAIN- | 5:Goto 6:Window 9:Calc F10:Graph  
 A14 [W6]:  
 ColWidth,Del,Erase,Ins,General,Summary,Borders,Window

Sheet	ATE	CHK #	CODE	AMOUNT	PAYEE	NOTE
Block	3/05	2345	UELEC	\$82.50	OTTER TAIL PWR CO.	FEB. 1996
CopyCell	3/09	2351	UTEL	\$53.68	U.S. WEST COMM.	JAN 20 - FEB 19
MoveCell	3/10	2352	UGAS	\$65.29	N.W. PUB.SERVICE	JAN 18 - FEB 16
Data	3/10	2353	UWATER	\$16.53	CITY OF MILBANK	JAN 15 - FEB 14
File		MARCH	TOTAL	\$218.00		
Graphics	4/03	2386	UELEC	\$71.46	OTTER TAIL PWR CO.	MAR. 1996
PrintTo	4/06	2389	UTEL	\$48.37	U.S. WEST COMM.	FEB 20 - MAR 21
USER	4/08	2390	UGAS	\$59.28	N.W. PUB.SERVICE	FEB 17 - MAR 18
Transfer	4/09	2391	UWATER	\$18.93	CITY OF MILBANK	FEB 15 - MAR 16
Exit		APRIL	TOTAL	\$198.04		
		MARCH +APRIL	TOTAL	\$416.04		

13  
 14  
 15  
 16  
 17  
 18 Fig. 2. SAMPLE ALITE SPREADSHEET - WITH MAIN MENU SUPERIMPOSED AT LEFT  
 19  
 20

UTILITIES.WKS Free: 99% [420k] Ovr . Cap . 9:41:35 pm

# ALITE, AN INEXPENSIVE, BUT POWERFUL SPREADSHEET - By Harold J. Hendriks

\*\*\*\*\*

F1:Help 2:Edit 3:Macro 4:Abs | -WSheet- | 5:Goto 6:Window 9:Calc F10:Graph

Set Column WIDTH

SHEET	..B...	.C...	.D...	...E....	.....F.....	.....G.....
	ATE	CHK #	CODE	AMOUNT	PAYEE	NOTE
ColWidth	3/05	2345	UELEC	\$82.50	OTTER TAIL PWR CO.	FEB. 1996
Delete	3/09	2351	UTEL	\$53.68	U.S. WEST COMM.	JAN 20 - FEB 19
Erase	3/10	2352	UGAS	\$65.29	N.W. PUB.SERVICE	JAN 18 - FEB 16
Border	3/10	2353	UWATER	\$16.53	CITY OF MILBANK	JAN 15 - FEB 14
Insert						
General						
Summary	4/03	2386	UELEC	\$71.46	OTTER TAIL PWR CO.	MAR. 1996
Window	4/06	2389	UTEL	\$48.37	U.S. WEST COMM.	FEB 20 - MAR 21
	4/08	2390	UGAS	\$59.28	N.W. PUB.SERVICE	FEB 17 - MAR 18
12	NHC 04/09	2391	UWATER	\$18.93	CITY OF MILBANK	FEB 15 - MAR 16
13			APRIL TOTAL	\$198.04		
14						
15			MARCH +APRIL TOTAL	\$416.04		
16						
17						
18	Fig. 3. SAMPLE ALITE SPREADSHEET - WITH SHEET MENU SUPERIMPOSED AT LEFT					
19						
20						

UTILITIES.WKS Free: 99% [420k] Ovr . Cap . 9:48:18 pm

F1:Help 2:Edit 3:Macro 4:Abs | -File- | 5:Goto 6:Window 9:Calc F10:Graph

Retrieve \*.W?? worksheet

FILE	..B...	.C...	.D...	...E....	.....F.....	.....G.....
	ATE	CHK #	CODE	AMOUNT	PAYEE	NOTE
Retrieve	3/05	2345	UELEC	\$82.50	OTTER TAIL PWR CO.	FEB. 1996
Store	3/09	2351	UTEL	\$53.68	U.S. WEST COMM.	JAN 20 - FEB 19
Merge	3/10	2352	UGAS	\$65.29	N.W. PUB.SERVICE	JAN 18 - FEB 16
Xport	3/10	2353	UWATER	\$16.53	CITY OF MILBANK	JAN 15 - FEB 14
Import						
Erase						
List	4/03	2386	UELEC	\$71.46	OTTER TAIL PWR CO.	MAR. 1996
Dir	4/06	2389	UTEL	\$48.37	U.S. WEST COMM.	FEB 20 - MAR 21
New	4/08	2390	UGAS	\$59.28	N.W. PUB.SERVICE	FEB 17 - MAR 18
UpLink	4/09	2391	UWATER	\$18.93	CITY OF MILBANK	FEB 15 - MAR 16
			APRIL TOTAL	\$198.04		
14						
15			MARCH +APRIL TOTAL	\$416.04		
16						
17						
18	Fig. 3. SAMPLE ALITE SPREADSHEET - WITH FILE MENU SUPERIMPOSED AT LEFT					
19						
20						

UTILITIES.WKS Free: 99% [420k] Ovr . Cap . 9:51:07 pm



Help! ... To view topic, highlight and press ENTER or ESC to exit

C O L U M N   O P E R A T I O N S

---

- To Set Current Column Width - /SCSxx[ENTER] (Arrow keys can be used to shrink/expand columns)
- To Set Global Column Width - /SGCxx[ENTER] (Only affects column widths not set individually)
- xx can be replaced by a formula which can be evaluated using the F9 (Calc) key before [ENTER] is pressed
- Delete Columns - /SDCrange[ENTER]
- Insert Columns - /SICrange[ENTER]

range = any valid range; can be typed in  
or highlighted using the arrow  
keys in the pointing method.

Fig. 5. HELP MENU , Index of Help Topics

Free: 100% [423k]      Ovr . Cap .      9:57:06 pm

BROWSE: use arrow keys to move Up or Down , Press ESC for topic List

C O L U M N   O P E R A T I O N S

---

- To Set Current Column Width - /SCSxx[ENTER] (Arrow keys can be used to shrink/expand columns)
- To Set Global Column Width - /SGCxx[ENTER] (Only affects column widths not set individually)
- xx can be replaced by a formula which can be evaluated using the F9 (Calc) key before [ENTER] is pressed
- Delete Columns - /SDCrange[ENTER]
- Insert Columns - /SICrange[ENTER]

range = any valid range; can be typed in  
or highlighted using the arrow  
keys in the pointing method.

Fig. 6. HELP SCREEN - COLUMN OPERATIONS

Free: 100% [423k]      Ovr . Cap .      9:59:04 pm

# ENGINEERING DEPARTMENT

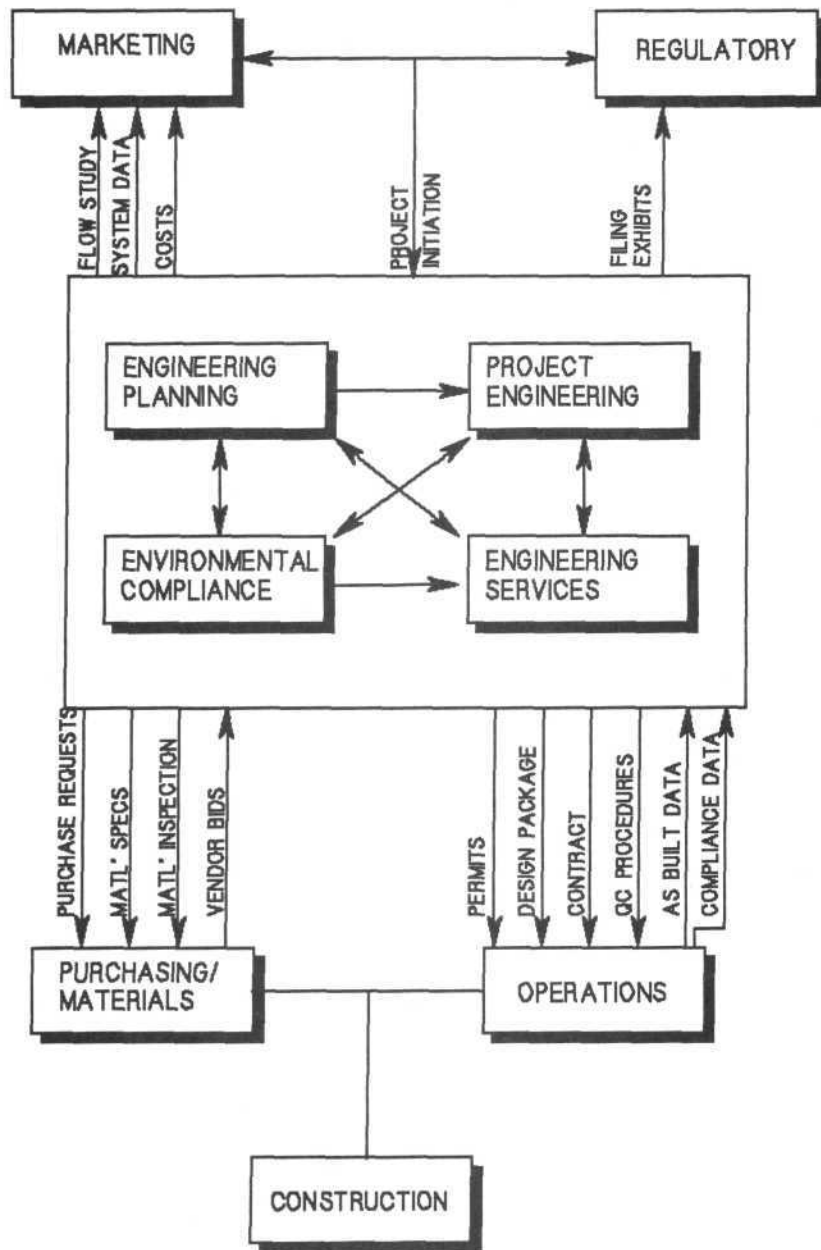

# COLONIAL HOUSE

DETAIL-1

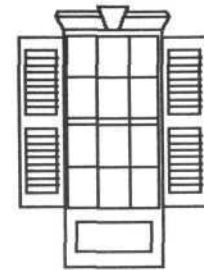

DETAIL-2

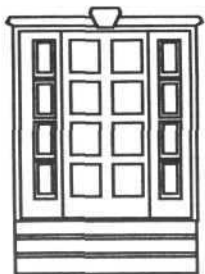

DETAIL-3

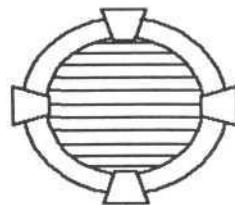



DRAFT House Layout (Not to Scale)  
Created with  
DRAFT Choice v2.15

---

Copyright 1994, TRIUS, Inc.

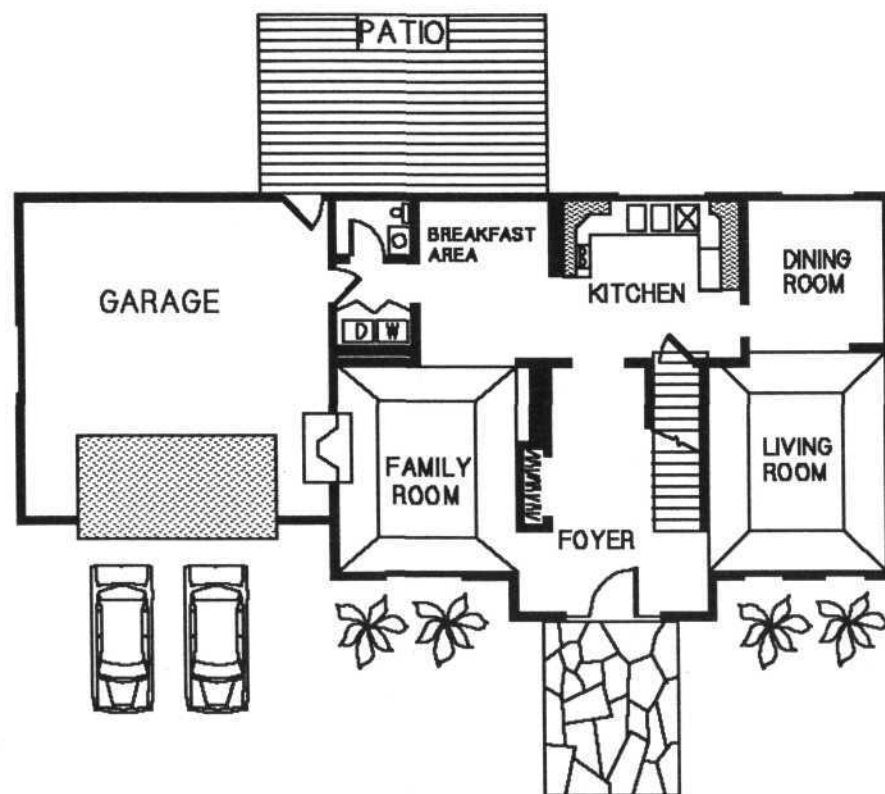

FIRST FLOOR LAYOUT

SECOND FLOOR LAYOUT

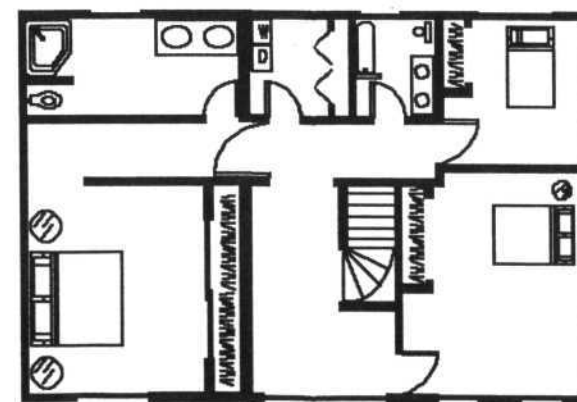

# NOTE:

ROOF STRUCTURE VARIES  
SEE SHT. #1 - MAY BE FLAT  
W/ BUILT UP ROOF OR PITCHED  
TRUSSED W/ ASPHALT SHINGLES

HURR CLIP @ EA  
JST. OR TRUSS

ALUM. FASCIA.

ALUM. SOFFIT

SEE PLAN FOR  
JST SIZE OR  
TRUSS SPACING

1/2" W.P. DRYWALL

SEE PLAN

BOLT COL. TO WD  
BEAM WITH STRAP  
SEE SHT #1 FOR BM  
SIZE.

3X3 STRUCT. ALUM  
COL. -SEE PLAN  
SHT. #1 FOR SPACING

BOLT COLUMN TO  
CONCRETE WITH  
HURR. COL. BASE  
OR STRAP

0.006 MIL. VISQ

SOIL POISON

COMP. FILL

2 - #5

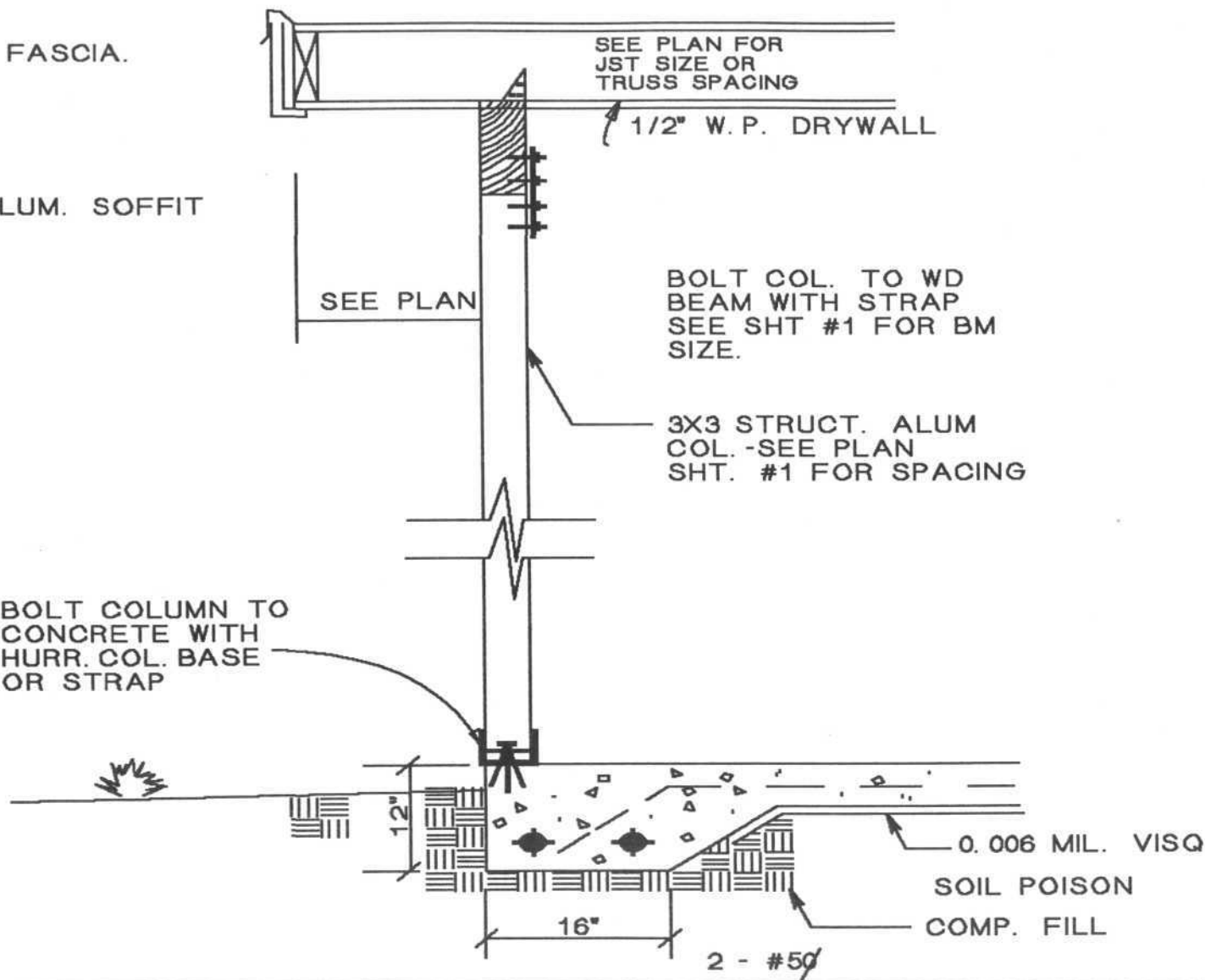

# PARSONS SOFTWARE GROUP

## HOME OR WORK GROUP

GOLF DIGEST SCORECARD 3.0 FOR WINDOWS	\$ 19.00
SCREEN DREAMS FOR WINDOWS	\$ 19.00
FUNDAMENTALS OF A MODEL SWING	\$ 19.00
SWING MAKER FOR WINDOWS	\$ 19.00
CROSSWORDS PLUS FOR WINDOWS	\$ 19.00
ADDRESS BOOK FOR WINDOWS	\$ 19.00
PHOTO PICS CD-ROM	\$ 19.00
PERSONAL HOME INVENTORY FOR WINDOWS	\$ 19.00
AMERICAN HISTORY EXPLORER FOR MULTIMEDIA CD-ROM	\$ 49.00
ATOMIC CLOCK FOR WINDOWS	\$ 19.00
ANNOUNCEMENTS FOR WINDOWS OR CD-ROM	\$ 19.00
MEDICAL DRUG REFERENCE FOR WINDOWS OR CD-ROM	\$ 19.00
HOME REMEDIES	\$ 19.00
FAMILY ORIGINS FOR WINDOWS <i>FREE SNAP SHOT SCANNING WITH YOUR PURCHASE OF FAMILY ORIGINS</i>	\$ 29.00
FAMILY LAWYER FOR WINDOWS OR CD-ROM <i>(formerly It's Legal)</i>	\$ 29.00
BUSINESS LAW PARTNER	\$ 29.00

## CHURCH AND BIBLE PRODUCTS

QUICK VERSE FOR WINDOWS	\$ 45.00
QUICK VERSE NEW BIBLE COLLECTION FOR CD-ROM	\$ 25.00
QUICK VERSE DELUXE BIBLE REFERENCE FOR CD-ROM	\$ 195.00
RYRIE STUD BIBLE	\$ 25.00
MATTHEW HENRY'S COMMENTARY	\$ 25.00
STRONG'S COMMENTARY	\$ 25.00
NEW SCOFIELD STUDY BIBLE	\$ 24.95
TREASURY OF SCRIPTURE	\$ 25.00
BELIEVER'S STUDY BIBLE	\$ 25.00
CHRISTIAN IMAGE BONUS PACK	\$ 39.00
HOLY LANDS SCREEN DREAMS	\$ 25.00
PC BIBLE ATLAS FOR WINDOWS	\$ 44.50
MEMBERSHIP PLUS for Windows or DOS	\$ 124.50
CLERGY TAX	\$ 45.00
HOLMAN BIBLE DICTIONARY	\$ 25.00
BIBLE ILLUSTRATOR FOR WINDOWS	\$ 45.00
HEBREW TUTOR CD-ROM	\$ 45.00
HOLMAN MULTIMEDIA BIBLE DICTIONARY/WINDOWS	\$ 25.00
THE NEW BIBLE COMPANION FOR CD-ROM	\$ 85.00

139 West 2nd Street Casper, WY 82601 (307) 235-4840

**Wyoming Software,**  
*Computers, and Accessories*

Mail Orders can be sent to:  
Computer News PO Box 50127 Casper, WY 82605  
Add \$5 for shipping and handling and 5% Sales Tax if shipped in Wyoming.  
Enclose check or money order with your order.



## AS-EASY-AS SPREADSHEET

SYSTEM REQUIREMENTS: PC/MS-DOS Version 3.01 or later, IBM AT/286 compatible or better.  
**450K minimum RAM.** Supports up to 8 meg. of EMS.

A powerful spreadsheet program with over 150 math, financial, scientific, statistical, string, date and time functions. Superb 2D and 3D graphics with color printer support. Full macro language implementation. 8,192 rows by 256 columns. Text/Graphics video modes. Up to 6 user definable views open at the same time and much more.

\$69.00 (Z) S&H

## ALITE SPREADSHEET

SYSTEM REQUIREMENTS: PC/MS-DOS Version 2.11 or later, IBM PC/XT/AT,286,386,486.PS/2 compatible. **256K minimum RAM.** Supports up to 8 meg. of EMS. A powerful spreadsheet program with a minimum hardware requirement. Over 70 math, financial, scientific, statistical, string, date and time functions. Five graph types, macro language support, file linkings and more.

\$20.00 (Z) S&H

## PIVOT SPREADSHEET UTILITY

SYSTEM REQUIREMENTS: PC/MS-DOS Version 2.11 or later, IBM PC/XT/AT,286,386,486.PS/2 compatible. **384K minimum RAM.**

A print utility program for use with AS-EASY-AS, and Alite, or compatible worksheet files. Print in portrait or landscape orientation for those wide spreadsheets in a choice of 3 NLQ fonts. A must for anyone requiring high quality output on their Epson or compatible printer.

\$15.00 (Z) S&H

## DraftChoice CAD Drawing/Drafting software

SYSTEM REQUIREMENTS: PC/MS-DOS Version 3.x or later, IBM PC/XT/AT,286,386,486.PS/2 compatible. **450K minimum RAM.** Disk Space: 1-720K 3.5" or 2-360K Floppy Disks.

A fast, powerful object-oriented CAD program with optimized XMS/EMS/Virtual Memory support. Intuitive commands and on-screen tool icons allow amazingly detailed drawings and conceptual schematics to be created with ease. Symbol library management, multiple fonts, parametric function generator, user-definable fill patterns and line styles. Supports Mouse, Digitizer (with mouse emulation), or keyboard. Supports 9 or 24 pin dot matrix printer, LaserJet, Postscript, HP-GL pen plotters.

\$49.00 (Z) S&H

## DraftChoice for Windows CAD Drawing/Drafting

SYSTEM REQUIREMENTS: Windows 3.1x and later. IBM 386, 486, Pentium compatibles.  
Disk space 2 MB minimum.

On screen tool icons allow amazingly detailed drawings to be created with ease. Contains drawing and editing commands needed to make accurate designs and conceptual schematics.

\$59.00 (Z) S&H

## **ProtoCAD 3D**

## **3D-CAD Drawing and Rendering**

**SYSTEM REQUIREMENTS:** PC/MS-DOS 3.2 or later. Windows 3.1 (runs as DOS application)

A fast 3-D CAD/Rendering program. Powerful commands quickly and easily turn 2-D into a 3D models. Extensive visual aids simplify modeling and Track Ball mechanism allows dynamic adjusting of user viewpoint.  
\$59.00 plus S&H

## **StarFlic**

## **Graphics Animation and Graphics Utility**

**SYSTEM REQUIREMENTS:** PC/MS-DOS, VER 3.3 OR HIGHER, IBM AT, 286, 386, 486, PS/2  
**384K RAM memory** (2MB EMS required for compiling PCX files).

A powerful flic (FLI) file compiler and player program. StarFlic creates animation flick files from collections of TGA and 16 color PCX image files. Feature include gray scale color mapping (up to 64 shades) and color intensity averaging for up to 256, plus colors. Options include frame delay, frame number display, single step mode, image intensity, video mode and more.  
\$29.99 (Z) S&H

## **Odyssey**

## **Communications Software**

**SYSTEM REQUIREMENTS:** PC/MS-DOS, VER 3.3 OR HIGHER, IBM AT, 286, 386, 486, PS/2  
**512K RAM memory.**

Winner of the 1992 UK PC Magazine Editor's Choice Awarded Odyssey is by far the best communications program around. This exceptional program even offers software-implemented MN4 and MN5 for error-free communications. This outstanding feature means there is no need to replace our old modem just to get error correction capabilities. Features superb terminal emulation's including VT52, VT100, VT320, and DG200.  
\$89.00 (Z) S&H

## **Odyssey for Windows**

## **Communications Software**

**SYSTEM REQUIREMENTS:** Windows 3.1 or higher IBM 386/486/Pentium and compatibles.  
**2 MB minimum memory. 3-1/2" HD Diskette**

The windows version of the the 1992 UK PC Magazine Editor's Choice Award winner. Odyssey is by far the best communications program around. This exceptional program even offers software-implemented MN4 and MN5 for error-free communications. This outstanding feature means there is no need to replace our old modem just to get error correction capabilities. Features superb terminal emulation's including VT52, VT100, VT320, and DG200.  
\$79.00 (Z) S&H

All programs are available on 3-1/2" 720K Double-Sided Double Density Diskettes and 5-1/4" Double Density Diskettes. Except Odyssey for Windows which is available on 3-1/2" High Density. Please specify disk size when ordering 3-1/2" or 5-1/4".



# COMPUTER NEWS PURCHASING CLUB

---

Become a Member and Save  
On Computer Hardware and Software

Save on  
Printers  
Ribbons  
Laser Cartridges  
Computers  
Compact Disks  
Floppy Disks  
Floppy Disk Drives  
Hard Disk Drives  
Computer Programs  
Multi-media  
Replacement Hardware  
Memory Expansion  
Any and all computer related products

---

*Detach and Mail With Payment*

☐ Yes, I want to become a member of COMPUTER NEWS PURCHASING CLUB.

Enclosed is my \$25.00 check or money order for my first years membership.

☐ And please rush my membership kit to me right away, I want to start saving as soon possible on my computer purchases.

NAME \_\_\_\_\_ PHONE \_\_\_\_\_

ADDRESS \_\_\_\_\_

CITY \_\_\_\_\_ STATE \_\_\_\_\_ ZIP \_\_\_\_\_

Check or Money Order Payment Only - Credit Card orders are not accepted.

**HARD TO FIND DISKETTES AT UNBELIEVABLE PRICES  
AND YOU NEED TO BUY ONLY 10 OR MORE TO GET THESE PRICES**

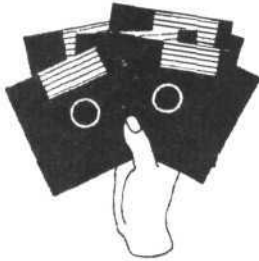

5.25" DOUBLE DENSITY  
WITH SLEEVES AND LABELS  
Premium Quality White Box of 10

\$ .17 each

5.25" DOUBLE DENSITY  
WITH SLEEVES  
Premium Quality Bulk Package of 10

\$ .15 each

5.25" HIGH DENSITY  
Premium Quality Bulk Package of 10

\$ .42 each

3.5" DOUBLE DENSITY  
Premium Quality Bulk Package of 10

\$ .41 each

3.5" HIGH DENSITY  
Premium Quality Bulk Package of 10

\$ .55 each

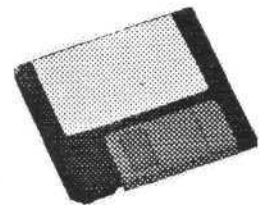

QUANTITIES LIMITED .... ORDER EARLY.....ADD SHIPPING FOR MAIL ORDERS  
ADD \$4 Shipping for 10 to 30 disks, \$6 FOR 31 to 50 disks, \$ 8 for 100 or more.

*When you are in Casper Wyoming visit*

## **Wyoming Software**

and Computer Accessories

139 West 2nd Street, Casper, WY 82601

Open noon till 6 PM Monday through Friday

11 am to 3 PM Saturdays.

Phone 307-235-4840

**COMPUTER PROGRAMS AND ACCESSORIES AT MAIL ORDER PRICES**

NEW RIBBONS FOR ALL PRINTERS  
CABLES OF ALL TYPES  
DISK & CD ROM DRIVES  
FAN FOLD MAIL LABELS

DISKETTES  
LASER TONER KITS  
DISK CLEANING KITS  
MOUSE AND JOYSTICKS

HUNDREDS OF SHAREWARE PROGRAMS \$1.00 to \$ 2.95 "TRY BEFORE YOU BUY"  
ALL OTHER PROGRAMS AT DISCOUNTED PRICES.  
ALL PROGRAMS ARE FULLY FUNCTIONAL.





## TRS-80 MODEL III/4 EMULATOR

By Jeff Vavasour

Run your TRS-80 Model 4  
and Model III Software on your PC.

Virtually all software available for your Model III or Model 4 will run on your IBM PC or PC Clone computer using The TRS-80 Model III/4 Emulator. Install TRSDOS 1.3, LDOS 5.x, NewDos (Model III DOSes) TRSDOS 6.x, LS-DOS 6.3.x, (Model 4 DOSes) on your PC.

A Model 4 or 3 and a PC with at least 384K, CGA graphics, MS-DOS 3.3 or higher is required. If you still have TRS-DOS disks but no longer have your Model 4 computer *Computer News Transfer Service* will transfer your files from your TRS-80 disks to the emulator formatted PC disks required for use in your PC, \$5 per disk.

\$ 59.95 plus \$4.00 Shipping and handling.

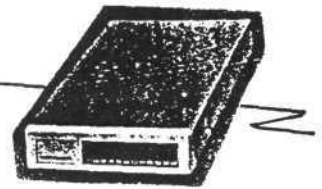

## 2400 Baud External Modem SUPER SPECIAL

WHILE QUANTITIES LAST!

**\$57.95**

\$4 S&H

2400 baud transmission speed  
Hayes compatible  
Compatible with Model 3/4/4D/4P  
Compatible with IBM PC/XT/AT  
Auto dial/answer  
Eight status indicator lights  
Built-in speaker with volume control  
Second jack for local phone  
Call progress and error detection  
Ten year manufacturer's warranty  
Manufactured in the USA

**Complete with**

**Communication Software**



FROM THIS



TO THIS

## IMAGE DOCUMENT STORAGE SERVICE

We will copy your paperwork to  
electronic files.

Cut down on storage space. Retrieve vital  
information and view on your computer  
screen or print copies.

Color photographs or black and white can be  
placed in electronic files for viewing or  
adding to documents.

Reasonable rates.

Let us quote on your project.  
Computer News 307-265-6483 or  
Wyoming Software 307-235-4840

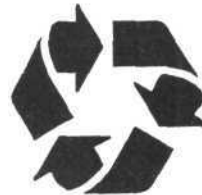

**STOP  
THROWING  
PRINTER  
CARTRIDGES  
AWAY!**

**RECYCLE THEM**

**WE WILL RE-INK THEM FOR YOU**

\$ 3.00 each

Fabric ribbons can be re-inked dozens of times before the fabric wears out. Even then the plastic cartridge will still be good and the ribbon can be replaced. Send us your used printer ribbons and we will re-ink them using high quality ink that also contains a print head lubricant to prolong the life of your printer.

Add \$3 Return Shipping for 1 to 5 ribbons,  
Add \$4 Return Shipping for 6 or more ribbons.  
Include your phone number and payment by check  
or money order to *Computer News*.



# HARD DISK CARDS

for Tandy 1000, 1000A, HD, SX, TX, SL's  
Computers

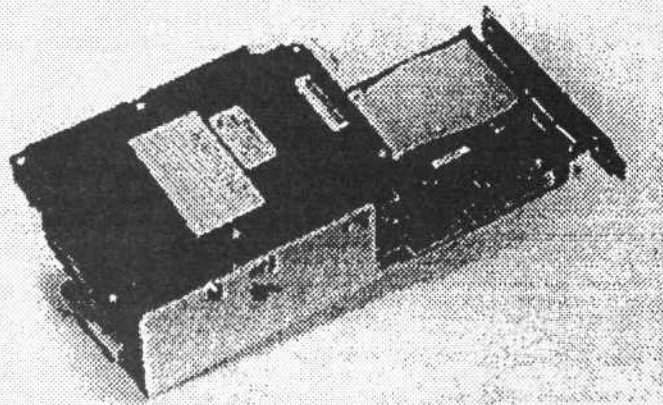

40 meg. IDE	\$229.95
-------------	----------

210 meg. IDE	\$272.95
--------------	----------

HARD CARD KIT WITHOUT HARD DRIVE \$69.95

Includes bracket, controller board and instructions.

Add \$6.00 for shipping and handling for hard drive items.

---

512K Memory Cards	\$120.00
-------------------	----------

Add \$5.00 for shipping and handling for memory cards.

# The Secrets Of The 1000's!

Our Hot  
Selling Video!

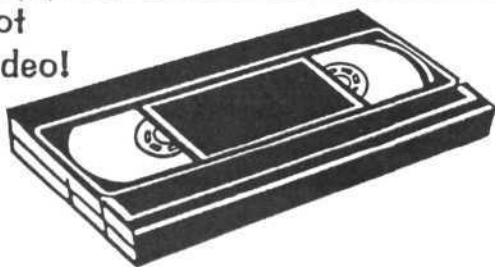

## Secrets Of The 1000's \$29.95

This 90 minute video reveals how to upgrade your 1000. It covers all the different models of the 1000's, even the EX and HX! Not sure how to install something in your system? You can now watch it being done! Learn all the secrets of installing hard drives, hard cards, memory, VGA cards, floppy drives and other upgrades! No more secrets! Learn how to make compatible parts work in your 1000. Even if you don't have a 1000, this video will help you in upgrading any PC!

Item # VID1 Order Yours Today!

### **\*\* Special Offer \*\***

**Secrets Of The 1000's Video  
Tech Notes & Jumpers Manual Vol. 1  
Tech Notes & Jumpers Manual Vol. 2  
Get All Three For Only \$59.95**

Shipping \$6

## **Tech Notes & Jumper Manual**

**Vol 1: The 1000's \$19.95**

**Vol 2: The Add-Ons \$19.95**

Vol 1: This book covers all of the 1000's! This book contains all the tech notes and jumper/switch settings for the 1000's. Tech notes on BIOS Rom's, video, com ports, printer ports, memory upgrades, pin outs, secrets of the SL's & TL's ROM and much, much more! Memory options, upgrading info, speed-up info, system updates that no one ever tells you about! If you own a 1000, then this book is a must have. The video refers to this book.

Vol 2: This book covers all the add-on products that Tandy produced. It contains all the jumper setting and info on hard drives, hard cards, modems, VGA cards, monitors, floppy drives, mice, clock cards, serial boards, printer port cards and more! If you ever purchase a used product for your Tandy, it may not have the manual. This book will help you configure it for your system. **FOR ALL TANDY SYSTEM, 1000's, 3000's, 4000's, 2500's, etc.**

## **1000 Owner's! Convert Your System To A 386 or 486 System!**

Other Companies Are Charging You A Fortune  
To Do Something This Simple!  
Read This Book, Then Do It Your Self and Save!

### **"Building A New System From Your Old Parts"**

Newly Revised

Did you know that your hard drive, hard card, floppy drives, keyboard, monitor, memory and other parts, can be used in another computer? This book show you how! For example, if you have a 1000SX computer, with a CM11 Monitor, 40 meg hard card, 2 floppy drives, modem and mouse, you could build a 386-40SX system for less than \$400! This is the example in the book! Item # BUILD

**Order Today! \$14.95 S&H \$4**

### **MEMORY UPGRADES**

**ADD 512K RAM TO YOUR  
TANDY 1000**

**\$120.00**

**\$4.00 S&H**

### **Order from:**

Computer News  
PO Box 50127  
Casper, WY 82605

**307-265-6483**

Include check or money order with your order.  
We do not accept credit card orders.  
C.O.D orders are accepted.

**1237 FILES FOR  
TRS-80  
MODEL 100, 102, 200  
NEC 8201A/8300  
AND KYOCERA RELATED  
COMPUTERS**

**A complete set of seven 3-1/2" disks.  
for \$19.50 + \$4.00 (S&H)**

**or**

**\$3.50 per disk + \$3.00 (S&H)**

**For catalog send \$2 to cover mailing costs.**

**Also available on 5-1/4" DD Disks.**

**Formats are MS-DOS and TRS/LSDOS  
User must transfer files to their Notebook  
computer.**

**Please specify disk size and format when  
ordering.**

**All NEW  
Wyoming Software Catalog.  
Hundreds of programs. Many that  
will run on the older computers  
with limited memory, as well as the  
latest Windows versions.**

Categories include:  
Business, Educational, Games,  
Utilities, Personal, Cooking,  
Clipart, Fonts and much  
more.

Send \$2.00 to cover postage,  
refundable with your first  
order of five or more disks.

**DOWNLOAD BY MAIL  
FREE SUPPORT  
Shareware and Public Domain.**

**5-1/4" - 360K  
FLOPPY DISK DRIVES**

For Tandy

1000	1000 HD
1000 A	1000 SL
1000 EX	1000 SX

**\$ 59.00 + \$4 Shipping and Handling**

**MOUNTING KIT**

**MOUNT 3-1/2" DRIVES IN 5-1/4" BAYS.**

**\$ 4.95 + \$4 Shipping and Handling**

**No shipping and handling charge if shipped with  
drives or other orders.**

**FLOPPY DRIVES FOR**

**2100, 2500, 3000, 4000 Series  
& Sensation**

3-1/2" 1.44 Meg	\$ 59.00 + \$4 (S&H)
5-1/4" 1.2 Meg	\$ 59.00 + \$4 (S&H)

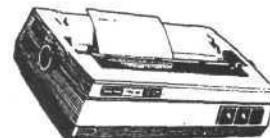

**PRINTCHIEF**

**The Printer Control Program for  
All Tandy DMP Printers**

**Menu Driven - Easy to use.**

**Create Reverse Type  
Bold and Double Strike  
Proportional, Condensed  
Wide, Double Height Letters  
Babyface 17 cpi, 15 cpi and 10 or  
12 cpi fonts, plus Hollow Fonts.**

**Bring your Tandy DMP Printer  
into the 90s with PrintChief.**

**In Stock Now for immediate  
shipment from Computer News PC.**

**\$ 24.95 plus \$ 4.00 S&H**



**Panasonic**  
Office Automation **OA**

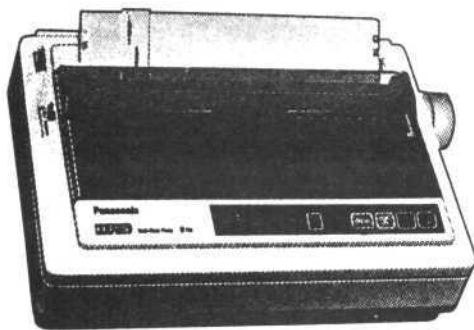

### Panasonic KX-P1150

*"Back to basics" 9-pin perfect for first time buyers*

Having trouble finding your first printer? Well, you can stop looking. Panasonic's KX-P1150 was specially designed for students and home users. This "back to the basics" printer includes features you want, like seven resident fonts, an easy-to-use front panel and a 240 cps print speed. It also has a flat-belt push tractor for easy paper loading and a utility disk that lets you make onscreen setup changes. The KX-P1150 has everything you need to produce great-looking, professional documents. Your search is over—order Panasonic's KX-P1150 today.

- 9-pin NLQ printing
- 160-240 cps high-speed draft/  
160 cps draft/32-38 cps NLQ
- 240 x 260 dpi
- 4K print buffer
- Parallel interface
- Epson FX-850 and  
IBM Proprinter III emulations
- Seven resident bit-mapped fonts
- Paper parking
- **FREE** setup disk with  
Windows 3.1 driver
- Two year manufacturer's warranty

**\$ 167.00 Plus \$6 S&H**

**Panasonic**  
Office Automation **OA**  
**KX-P2023**

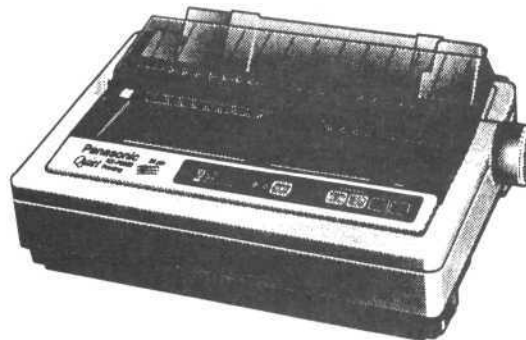

Put an end to printer set-up hassles with Panasonic's economical KX-P2023. This 24-pin printer makes high-quality printing a cinch—thanks to its EZ Set operator panel. EZ Set remembers more than 20 functions—including font, pitch, form length and emulation. At the touch of a button, the KX-P2023 recalls the most often used printer functions. Imagine the time you'll save printing your next brochure, form letter or report. For added versatility, Panasonic included advanced features like a 360 dpi resolution, seven LQ fonts, automatic loading and a flat belt tractor for simple fanfold paper loading. But best of all, it has the feature you've been waiting for—a low price.

#### Features:

- 24-pin LQ printing
- 160-240 cps draft/53-80 cps LQ
- 43.5 dBA noise level
- IBM Proprinter X24E and  
Epson LQ-850 emulations
- 11.7" mid-sized paper carriage
- 360 dpi
- Seven resident bit-mapped fonts
- EZ Set operator panel
- IBM PC-compatible set-up disk
- 14K print buffer
- Two year manufacturer's warranty

**\$ 220.00**

**\$6.00 S&H**

**RIBBON PRICE LIST**  
**NOVEMBER 1995**

<u>Stock #</u>	<u>Type</u>	<u>Printer</u>	<u>Each</u>	<u>6+</u>
CN1002	FC-BLK	LP III, V	6.38	5.88
CN1004	FC-BLK	LP VI/VIII, DMP 400/420	5.60	5.10
CN1005	FC-BLK	DMP110, SCM FIGUREMATIC 450	6.58	6.08
CN1008	FC-BLK	DMP 500, TEC-S75	13.40	12.90
CN1009	FC-BLK	DMP 120, 200	7.00	6.50
CN1013	FC-BLK	DMP430,436	12.25	11.75
CN1014	FC-BLK	DMP440,SEIKOSHA MP-5300AI/SK-3005AI	19.30	18.80
CN1015	FC-BLK	DMP2100, 2100P, 2110 TOSHIBA P321/351 SX/134/1350	6.10	5.60
CN1017	FC-BLK	DMP2120, FUJITSU DL2400/2600/DOT MAX 24	13.55	13.05
CN1019	FC-BLK	LMP/DMP2150,PRINTRONIX P300/600/6000/9000	8.00	7.50
CN1020	M-S	DWP II,DWP410/510,RICOH RP1200/1300/1600	5.35	4.85
CN1022	FC-BLK	DWP II, DWP410/510, RICOH RP1200/1300/1600	6.55	5.95
CN1024	M-S	DWP 520,230,210 DIABLO HYTYPE II	5.15	4.65
CN1026	FC-BLK	DWP 520/230/210 DIABLO HYTYPE II	5.60	5.10
CN1028	M-S	DWP220, RICOH RP2200Q/510/710	7.95	7.45
CN1030	FC-BLK	DMP 300/2102/2103, OKIDATA ML390/391	6.85	6.35
CN1032	FC-BLK	ALPS ASP-1000,1600/C.ITOH PROWRITER.JR	6.60	6.10
CN1033	FC-BLK	EPSON FX/RX/MX-80	5.50	5.00
CN1034	FC-BLK	EPSON LX/80/86/90	5.00	4.50
CN1035	FC-BLK	PANASONIC KX-P1090/91/92/1124/1595	6.10	5.60
CN1037	FC-BLK	STAR NX1000/LC-10	6.45	5.95
CN1038	FC-BLK	LP VII, DMP 100	6.00	5.50
CN1039	FC-BLK	PANASONIC 1180/1190/1191/2023	6.90	6.40
CN1041	FC-BLK	SEIKOSHA SP-2000/2400/DMP130/130A/132/133/107	6.40	5.90
CN1045	FC-BLK	ALPS ALLEGRO 24/500	7.25	6.75
CN1046	FC-BLK	DMP202/203/204/205/206/SEIK SL-90/70	7.25	6.75
CN1047	FC-BLK	SEIKOSHA SL270,230AI	15.40	13.86
CN1048	FC-BLK	STAR NX10,NB2410,ND/NP/NR-10	6.32	5.82
CN1049	FC-BLK	DMP2200/C.ITOH CI-3500/4000/5000	12.39	11.89
CN1050	FC-BLK	DMP136,240,250,207 CITIZEN GSX-140/130/200G	4.38	3.88
CN1051	FC-4C	DMP136,240,250,207 CITIZEN GSX-140/130/200G	16.68	16.18
CN1052	FC-BLK	DMP2104/FACIT B2150/2450/TEC GP-3411	10.71	10.21
CN1053	FC-BLK	DMP2130/C.ITOH C-645	23.25	22.75
CN1056	FC-BLK	EPSON LQ100/AP3250	7.71	7.21
CN1057	FC-BLK	EPSON LQ1000/1010/1050	4.86	4.36
CN1058	FC-BLK	EPSON LQ800/850	4.77	4.27
CN1059	FC-BLK	IBM PROPRINTER/4201	6.93	6.43
CN1062	M/S	WP 100/101/ROYAL ALPHA 600	4.59	4.19
CN1063	FC-BLK	IBM 2380/2381/2390/2391	6.75	6.25

FC-BLK = NYLON FABRIC CARTRIDGE-BLACK  
M-S = MULTI-STRIKE FILM CARTRIDGE-BLACK  
4C = NYLON FABRIC CARTRIDGE-FOUR COLOR

Add for Shipping and Handling  
1 to five ribbons add \$3.00 ... 6 or more ribbons ad \$4.00

Some ribbons for older printers are not stocked, but are still available by special order, please allow an additional week shipping time. All stock ribbons are shipped within 24 hours from the time the order is received. C.O.D. orders are accepted, C.O.D. charges are additional to shipping and handling charges. Government and educational institution purchase orders are accepted.

# Computer News PC Product Guide

## PROGRAMS

PACK - MS-DOS Version \$ 18.95 (Z)  
BASIC Program Packer by David Goblen.

MS UTILITIES by David P. Miller \$ 30.00 (Z)  
Transfer files between TRS/LS DOS disks and  
MS-DOS disks. Format MS disks on a model 4.

SAVE & GO by David Goblen \$ 18.95 (Z)  
MS-DOS Directory Utilities (see Vol 3.1)

## DISKETTES

American Made - Bulk Platinum Brand by Syncom.

## FLOPPY DISKS DOUBLE DENSITY

5-1/4 DS/DD 360k. \$ .38 (Z)  
100% Error Free Lifetime Guarantee with  
Paper Sleeves, Labels & Read/Write Tabs.

3-1/2" DS/DD 720k \$ .59 (Z)  
Premium Quality complete with labels,  
100% Error Free, Lifetime Warranty.

## FLOPPY DISKS HIGH DENSITY

5-1/4 DS/HD 1.2meg \$ .58 (Z)  
100% Error Free Lifetime Guarantee  
with Paper Sleeves, Labels & Read/Write Tabs.

3-1/2" DS/HD \$ .69 (Z)  
Premium Quality complete with labels,  
100% Error Free, Lifetime Warranty.

5-1/4" TYVEK SLEEVES (25 per pk) \$ 1.25 (W)

## COLOR CODED DISK LABELS

Five Color 5.25 Write-On Disk Labels  
10 labels w/10 read-write tabs per sheet  
100 per package \$ .50 (W)

## FLOPPY DISK MAILERS

Self-Sealing Mailer package of 10 \$ 3.35 (Z)  
Holds one or two 5-1/4 floppy disks.

## SELECTOR SWITCHES

A-B SWITCH, PARALLEL \$ 14.75 (Z)  
With three female 36 conductor centronics connectors.  
A-B SWITCH, SERIAL, RS232 \$ 12.75 (Z)  
With three DB25 Female connectors.  
THREE POSITION SERIAL SWITCH \$ 16.95 (Z)  
w/4 DB25 Female connectors

## CABLES REQUIRED BETWEEN AB SWITCH and PRINTER

Printer to Selector Switch 6' M-M \$ 13.49 (Z)  
Printer to Selector Switch 10' M-M \$ 15.95 (Z)  
Printer to Selector Switch 15' M-M \$ 18.95 (Z)

## RS232/MODEM CABLES

Serial Cable 6 ft. DB-25 M TO DB-25 F \$ 6.95 (Z)  
Serial Cable 6 ft. DB-25 M TO DB-25 M \$ 6.95 (Z)  
Serial Cable 3 ft. DB-9 F TO DB-25 M \$ 6.00 (Z)  
Serial Cable 6 ft. DB-9 F TO DB-25 M \$ 6.95 (Z)

NULL MODEM Cable 6 ft DB-25 M TO DB-25 F \$ 6.95 (Z)  
Connect two computers together.

## PRINTER CABLES

For PC IBM/Compatible Computers to Parallel Printers.  
Round 6 ft. Parallel Printer Cable \$ 9.05 (Z)  
Round 10 ft. Parallel Printer Cable \$ 10.35 (Z)

For Tandy 1000 Computers to Parallel Printers.  
Flat Ribbon 6' Parallel Printer Cable \$ 12.95 (Z)  
Flat Ribbon 12' Parallel Printer Cable \$ 15.00 (Z)

## DISK CLEANING, DUST COVERS

5-1/4" DISK DRIVE CLEANING KIT \$ 4.90 (Z)  
3-1/2" DISK DRIVE CLEANING KIT \$ 5.25 (Z)  
UNIVERSAL PRINTER DUST COVERS \$ 9.75 (Z)  
For printers up to 16" wide, anti-static vinyl.

## INTERNAL HALF HEIGHT DOUBLE SIDED DISK DRIVES

Internal Half Height 5-1/4 360K \$ 59.00 (Z)  
Internal Half Height 5-1/4 1.2 meg. \$ 59.00 (Z)  
Internal Half Height 3-1/2 1.44 meg. \$ 59.00 (Z)  
Internal 2 Floppy Drive Cable IBM style \$ 2.35 (Z)

## DRIVE MOUNTING KITS

Floppy Disk Kit for 3.5" drive in 5.25 Bay \$ 4.95 (Z)  
Hard Drive for 3.5" HD in 5.25 Bay \$ 7.00 (Z)

## ADD SHIPPING & HANDLING CHARGES LISTED BELOW TO YOUR ORDER

\$10 Maximum S&H charge for United Parcel Ground Service. Add the shipping and handling charges per item ordered, if it exceeds \$10 for shipment in the 48 states then add only \$10 to your order for shipping and handling.

(X) Add \$ 3.00 (Y) \$ 4.00 (Z) \$ 5.00 (S) \$ 7.00

Shipments are made by UPS ground service whenever possible. Please use street address and include phone number when ordering. Consistent with industry standards no refunds are made for opened software, manuals, integrated circuit chips or computer parts. Replacement limited to defective material only. No returns without written authorization.

Check or Money Order Payment Only - We do not accept Credit Card orders. C.O.D. add an additional \$4.50 per order. APO, FPO, HI, AK, PR, and Canada add an additional \$2 per order unless otherwise stated. Wyoming Residents Only add 5% Sales Tax. Prices subject to change without notice.

Order from: Computer News, PO Box 50127 680, Casper, WY 82605-0127 (307)265-6483

Monday thru Friday - 8am thru 5pm - Mountain Time. Government, School, and Rated Corporation POs Welcome

Computer News PC  
Published bi-monthly.

Copyright (c) 1996  
by The Construction  
News Publishing Co.

Single issue \$4.00  
Subscription Prices:  
\$24 per year in US.  
\$36.00 per year in  
Canada. \$42.00 all  
others outside US.

Mailing Address:  
PO Box 50127  
Casper, WY 82605

Street Address:  
1220 Jamaica Drive  
Casper, WY 82609

Phone: (307) 265-6483

Classified Advertising  
Rates:

\$6.00 Minimum  
\$1.00 per line of 35  
characters or spaces.

Publishers and Editors  
Stan Slater  
Ron Gatlin

Office Hours are  
8 AM to 5 PM  
Mountain Time  
Monday thru Friday.

We also publish  
Computer News 80  
The Support Magazine  
for the Radio Shack  
Model I, III 4/4P/4D

## SUBSCRIPTION ORDER Receive a free software disk

Yes, enter my subscription to *Computer News PC*

\_\_\_ One year for just \$24.00 \_\_\_ Two years for just \$40.00

Name \_\_\_\_\_

Address \_\_\_\_\_

City \_\_\_\_\_ State \_\_\_\_\_ Zip \_\_\_\_\_

Check or Money order enclosed. Please send the  
Wyoming Software Disk of my choice. Disk # \_\_\_\_\_

Computer News PO Box 50127 Casper, WY 82605

## 160 pLus SCALEABLE TRUE TYPE FONTS

\$6.95

## 2,000 pLus CLIPART FILES

\$6.95 per volume

Three or more 3.5" or 5.25" disks per volume.

CD ROM player not required.

Have the best without needing huge memory.

Order Clipart Volume 1, 2, 3 or 4.

Add \$4 per order for shipping and handling

Computer News  
PO Box 50127 Casper, WY 82605

FORWARDING & RETURN POSTAGE GUARANTEED  
ADDRESS CORRECTION REQUESTED

BULK RATE  
U.S. POSTAGE  
PAID  
CASPER, WY  
PERMIT NO. 309

10449 95/07 96/05  
JEFFREY L HAYES  
130 FOREST AVE LOT 1  
ORONO ME 04473